



**Scotland Green Road North, EN3 7AU**

£375,000

Freehold

**Castles**







**Scotland Green Road North,  
EN3 7AU**

An older style 3 bedroom mid terraced family house located in a cul-de-sac off Alma Road within approx 0.3m from Ponders End train station (serving London Liverpool Street/Tottenham Hale) and close to local schools. The property would be an ideal first time buyer or buy to let opportunity. Viewing is recommended. Features include: double glazing, gas central heating, through lounge, ground floor bathroom, 3 spacious bedrooms, south facing rear garden, viewing recommended.

EPC Rating: D  
Current: 66 Potential: 83

Council Tax Band: D

**£375,000 Freehold**

**Castles**

**020 8804 8000  
enfield@castles.london**





**APPROXIMATE GROSS INTERNAL AREA**  
79.52 sqm / 855.94 sqft

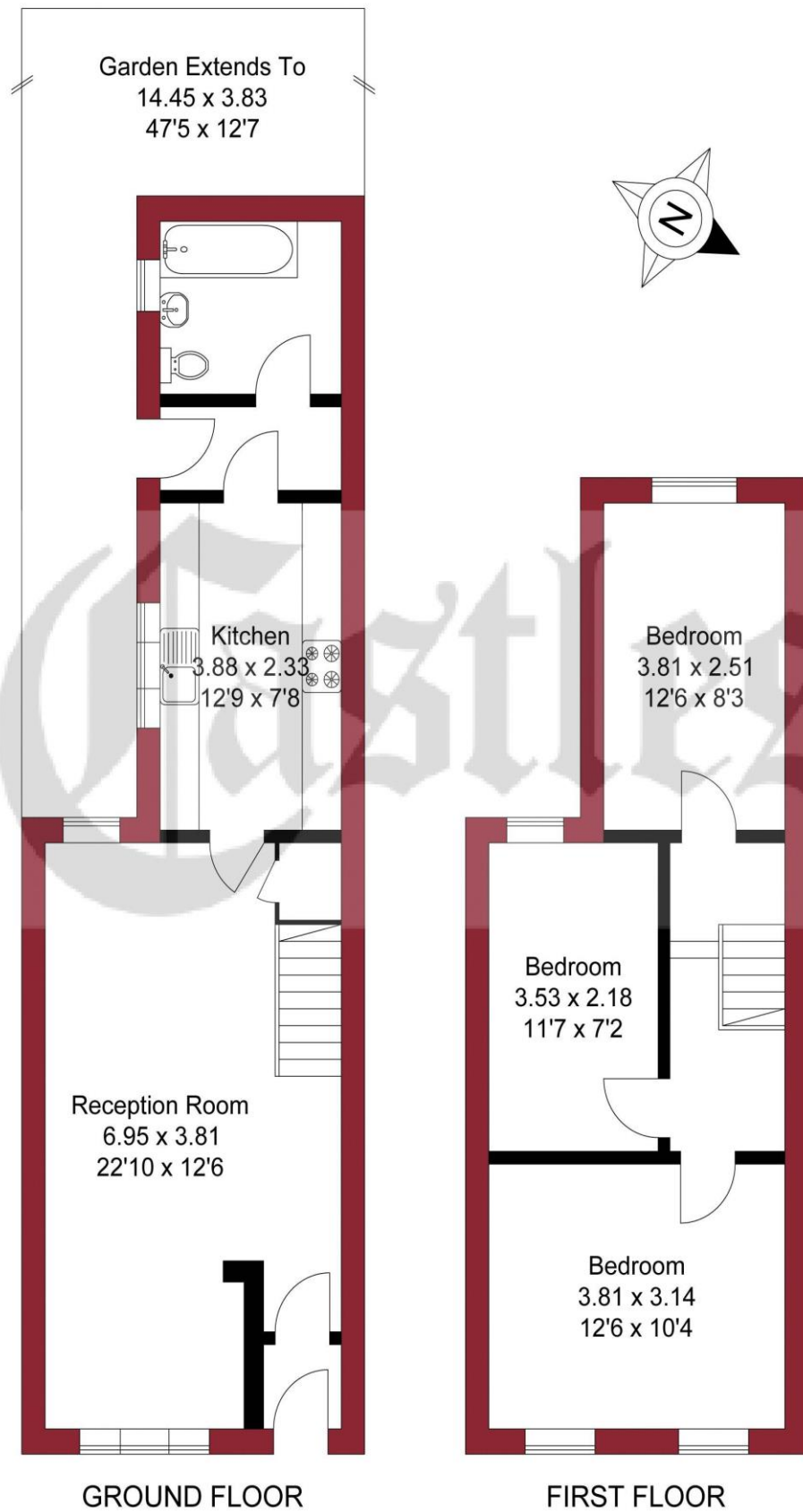

THIS PLAN IS FOR ILLUSTRATION ONLY AND MAY NOT BE REPRESENTATIVE OF THE PROPERTY

**An overview of Enfield**

Enfield boasts a proud and distinguished history, home to several country houses and ancient monuments, the area also hosts a notable contingent of famous residents both past and present.

With affordable homes and a safe, green environment, Enfield attracts many buyers pleasantly surprised by the good value of property compared to some of the more pricey neighbouring boroughs.

On the lush, green perimeter of London, Enfield has excellent transport links with a quick and easy train journey into the City and West End.

There are a range of activities to keep residents busy in the borough with seven bustling shopping areas, 900 hectares of parks, three golf clubs, and numerous cinemas, theatres and museums. There is a diverse community residing in the area.

Notable for its range of great schools, vast green spaces and bustling retail centres, as well as good transport links to the rest of the city, Enfield is undoubtedly a thriving place to live and work and proves an excellent choice for first time buyers, families, young professionals and property investors alike."

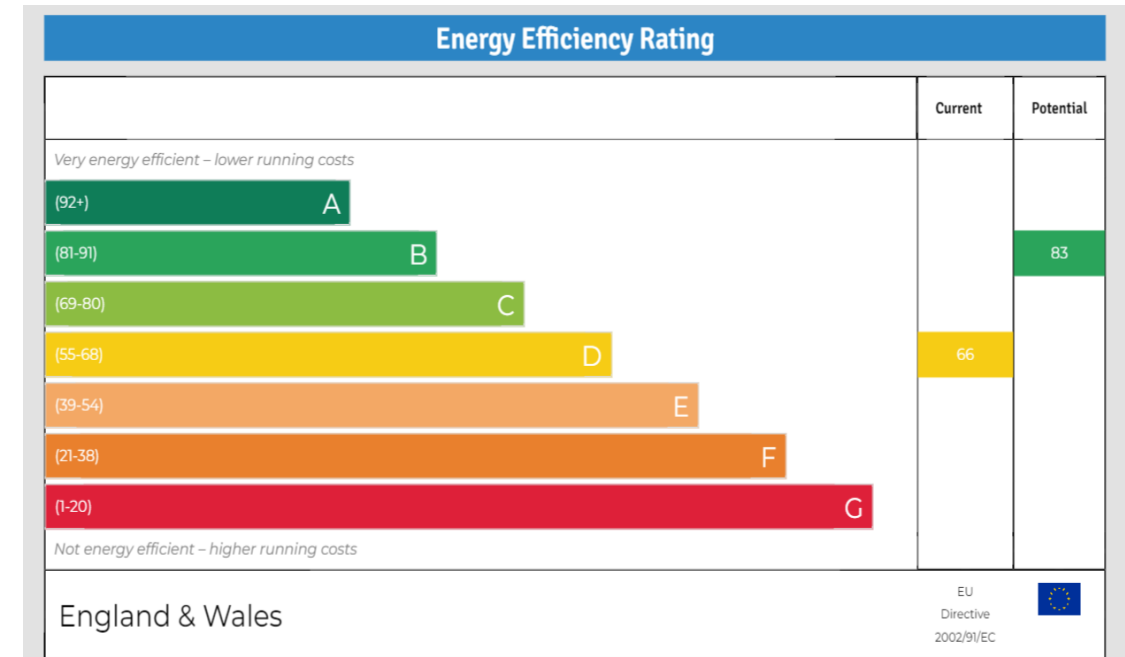

243-245 Hertford Road  
Enfield, EN3 5JJ  
0208 804 8000  
enfield@castles.london  
www.castles.london

All details including floorplans are for representation purposes only and do not constitute a contract or warranty. Whilst every effort is made to ensure accuracy of descriptions and measurements, no responsibility is taken for errors, omissions and misstatements.

