



Greenwood Avenue, EN3 5DN

£425,000

Freehold

Castles



Greenwood Avenue, EN3 5DN

An extended 3 bedroom end of terrace house located off Carterhatch Road within approx 0.4m of Brimsdown train station (serving London Liverpool Street/Tottenham Hale) and close to a selection of schools, shops and bus routes. The property is offered for sale chain free and viewing is recommended. Features include: end of terrace, 3 bedrooms, gas central heating, through lounge, extended kitchen with island, ground floor family bathroom, garage to rear via a service road, useful outbuildings, chain free sale.

EPC Rating: E
Current: 47 Potential: 87

Council Tax Band: D

£425,000 Freehold

Castles

020 8804 8000
enfield@castles.london



APPROXIMATE GROSS INTERNAL AREA
 75.04 sqm / 807.72 sqft (Excluding Outbuilding)
 117.59 sqm / 1265.72 sqft (Including Outbuilding)

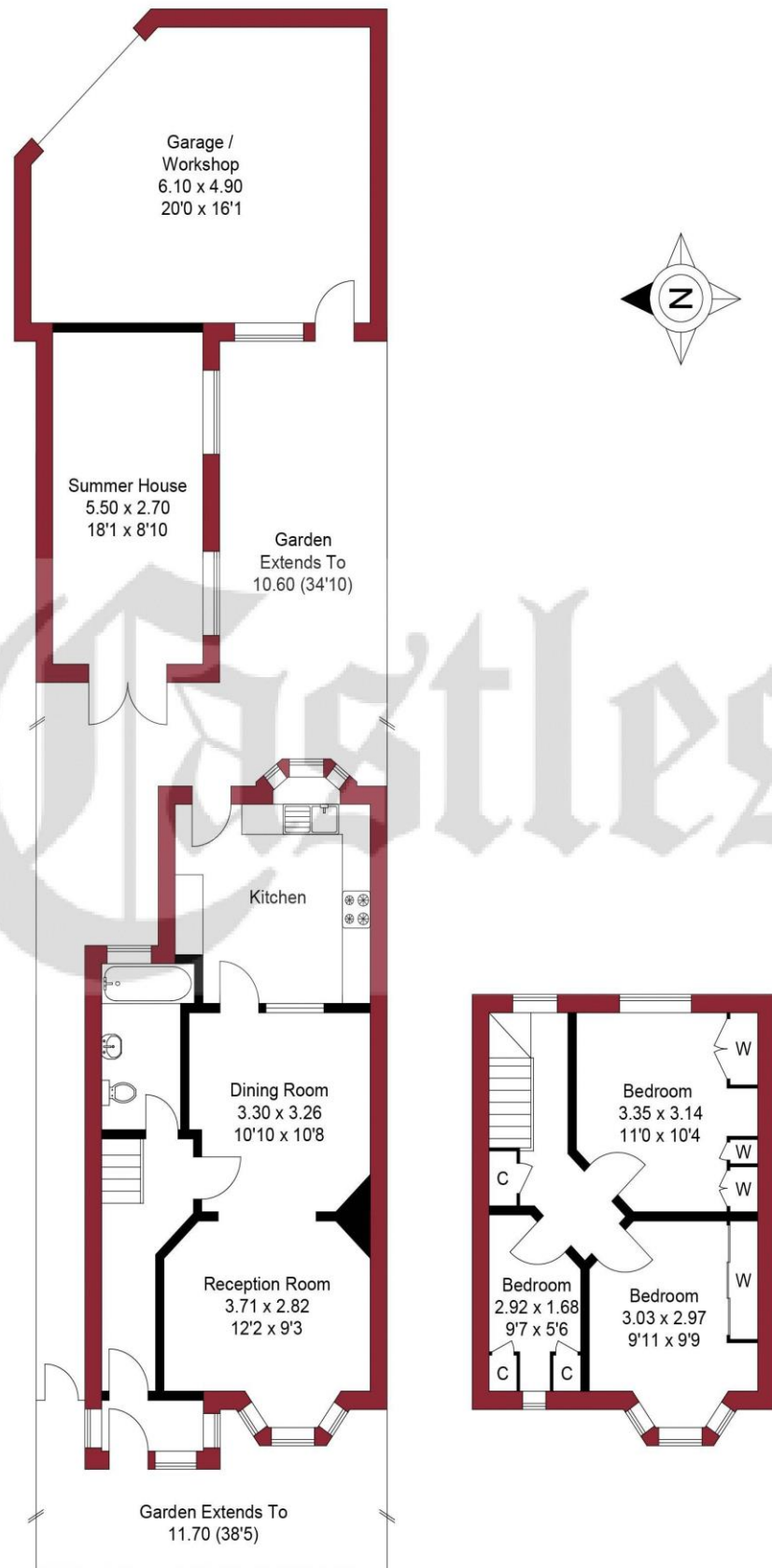

GROUND FLOOR

FIRST FLOOR

THIS PLAN IS FOR ILLUSTRATION ONLY AND MAY NOT BE REPRESENTATIVE OF THE PROPERTY

An overview of Enfield

Enfield boasts a proud and distinguished history, home to several country houses and ancient monuments, the area also hosts a notable contingent of famous residents both past and present.

With affordable homes and a safe, green environment, Enfield attracts many buyers pleasantly surprised by the good value of property compared to some of the more pricey neighbouring boroughs.

On the lush, green perimeter of London, Enfield has excellent transport links with a quick and easy train journey into the City and West End.

There are a range of activities to keep residents busy in the borough with seven bustling shopping areas, 900 hectares of parks, three golf clubs, and numerous cinemas, theatres and museums. There is a diverse community residing in the area.

Notable for its range of great schools, vast green spaces and bustling retail centres, as well as good transport links to the rest of the city, Enfield is undoubtedly a thriving place to live and work and proves an excellent choice for first time buyers, families, young professionals and property investors alike."

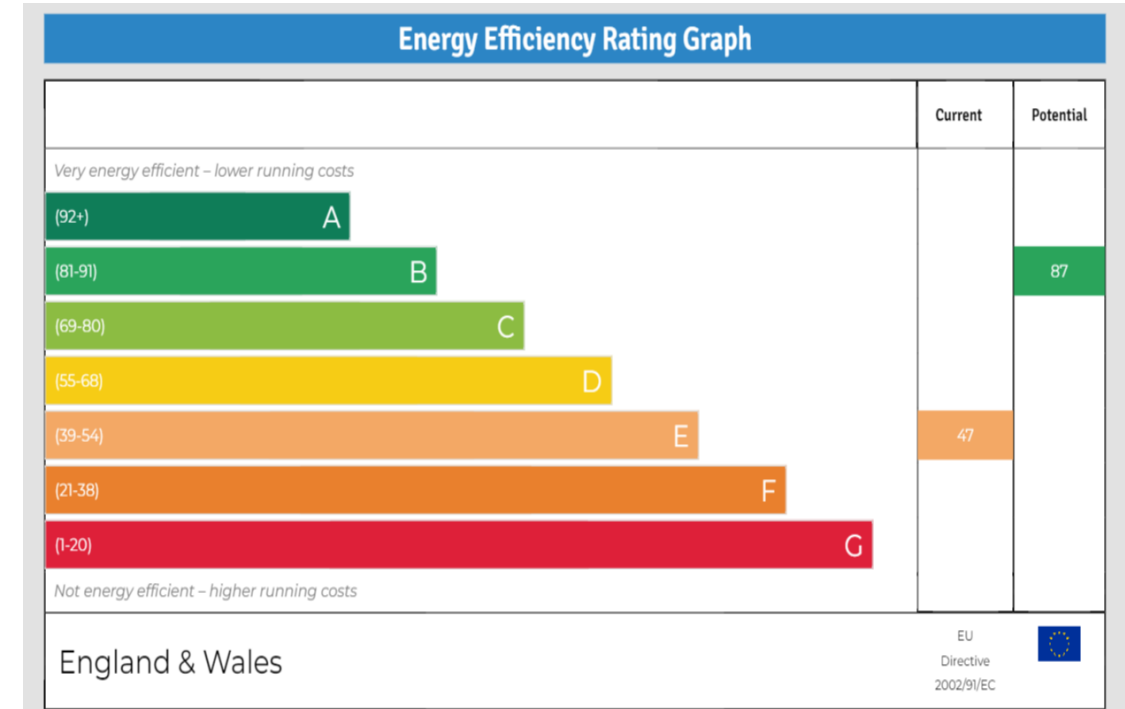

243-245 Hertford Road
 Enfield, EN3 5JJ
 0208 804 8000
 enfield@castles.london
 www.castles.london

All details including floorplans are for representation purposes only and do not constitute a contract or warranty. Whilst every effort is made to ensure accuracy of descriptions and measurements, no responsibility is taken for errors, omissions and misstatements.

rightmove find your happy Zoopla Smarter property search PrimeLocation Find the home you deserve

The Property Ombudsman A free, fair and independent service for buyers, sellers, tenants and landlords of property in the UK.

NAEA National Association of Estate Agents LICENSED MEMBER